

ST560S SCHOTTKY RECTIFIER



Features

- 150°C T_J operation
- Center tap configuration
- Low forward voltage drop
- High purity, high temperature epoxy encapsulation for enhanced mechanical strength and moisture resistance
- High frequency operation
- “-A” is an AEC-Q101 qualified device
- Terminals finish: 100% Pure Tin
- This is a Halogen Free Device
- All SMC parts are traceable to the wafer lot
- Additional testing can be offered upon request

Circuit Diagram

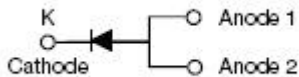

Applications

- Switching power supply
- Converters
- Free-Wheeling diodes
- Reverse battery protection

Maximum Ratings:

| Characteristics | Symbol | Condition | Max. | Units |
|--|--|---|------|-------|
| Peak Repetitive Reverse Voltage Working Peak Reverse Voltage DC Blocking Voltage | V _{RRM} V _{RWM} V _R | - | 60 | V |
| Average Rectified Forward Current | I _{F (AV)} | 50% duty cycle @T _L =125°C, rectangular wave form | 5 | A |
| Peak One Cycle Non-Repetitive Surge Current | I _{FSM} | 8.3ms, Half Sine pulse, T _J = 25 °C | 100 | A |

Electrical Characteristics:

| Characteristics | Symbol | Condition | Typ. | Max. | Units |
|-----------------------|-----------------|--|--------------|-----------|-------|
| Forward Voltage Drop* | V _{F1} | @ 2.5A, Pulse, T _J = 25 °C @ 5A, Pulse, T _J = 25 °C | 0.42 0.50 | - 0.70 | V |
| | V _{F2} | @ 2.5A, Pulse, T _J = 125 °C @ 5A, Pulse, T _J = 125 °C | 0.33 0.44 | - 0.60 | V |
| Reverse Current* | I _{R1} | @V _R = rated V _R , T _J = 25 °C | 0.01 | 0.7 | mA |
| Reverse Current* | I _{R2} | @V _R = rated V _R , T _J = 125 °C | 6.4 | 25 | mA |
| Junction Capacitance | C _T | @V _R = 5V, T _C = 25 °C f _{SIG} = 1MHz | 314 | - | pF |

* Pulse width < 300 μs, duty cycle < 2%

Thermal-Mechanical Specifications:

| Characteristics | Symbol | Condition | Specification | Units |
|--|-----------------|-----------|---------------|-------|
| Junction Temperature | T_J | - | -55 to +150 | °C |
| Storage Temperature | T_{stg} | - | -55 to +150 | °C |
| Typical Thermal Resistance Junction to Case | $R_{\theta JC}$ | - | 3.5 | °C/W |
| Typical Thermal Resistance Junction to Ambient | $R_{\theta JA}$ | - | 70 | °C/W |
| Approximate Weight | wt | - | 0.08 | g |

Ratings and Characteristics Curves

Figure 1
Typical Forward Characteristics

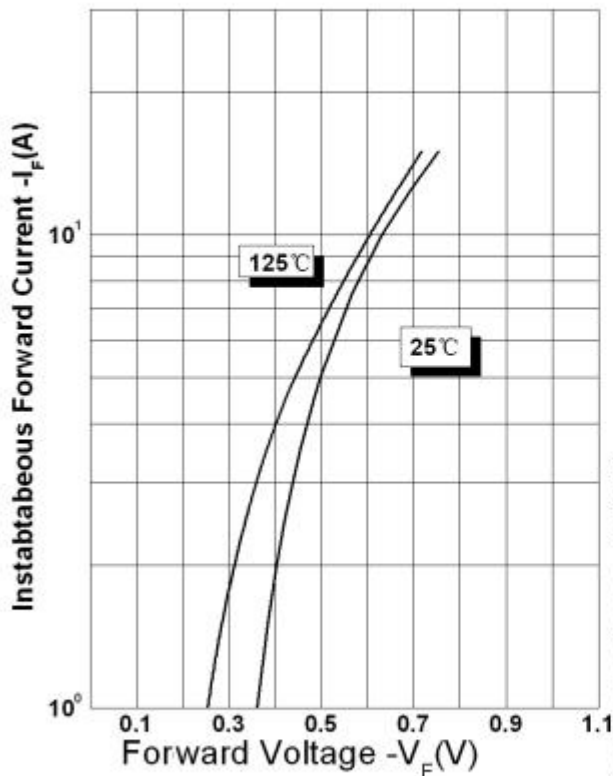

Figure 2
Typical Reverse Characteristics

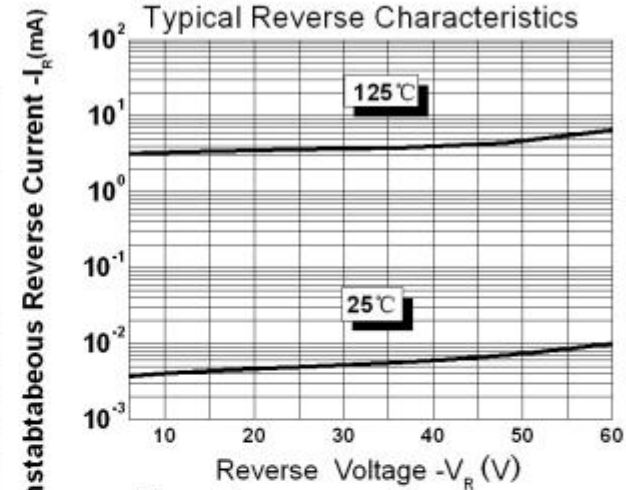
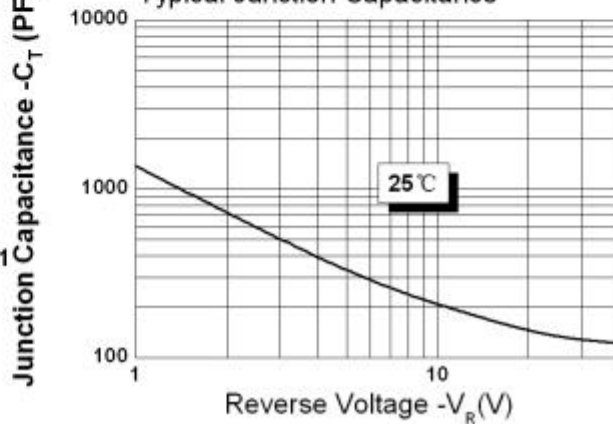
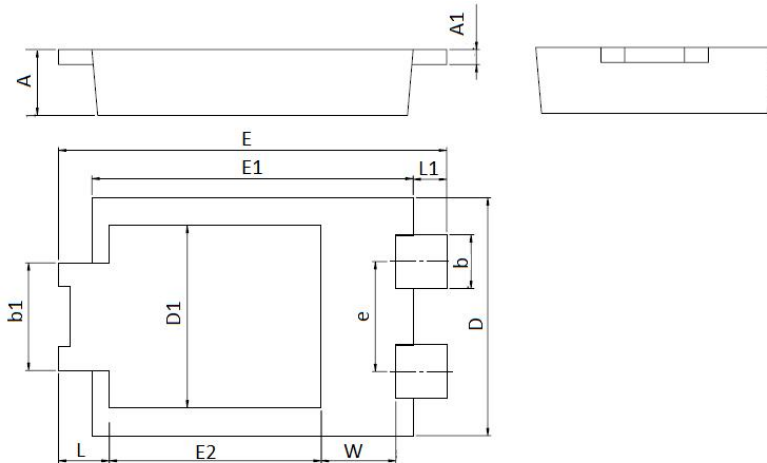

Figure 3
Typical Junction Capacitance



Mechanical Dimensions TO-277B



| SYMBOL | Millimeters | | Inches | |
|--------|-------------|------|--------|-------|
| | Min. | Max. | Min. | Max. |
| A | 0.95 | 1.25 | 0.037 | 0.049 |
| A1 | 0.20 | 0.30 | 0.008 | 0.012 |
| b | 0.85 | 0.95 | 0.033 | 0.037 |
| b1 | 1.70 | 1.90 | 0.067 | 0.075 |
| D | 3.88 | 4.08 | 0.153 | 0.161 |
| D1 | 2.90 | 3.20 | 0.114 | 0.126 |
| e | 1.74 | 1.94 | 0.069 | 0.076 |
| E | 6.30 | 6.70 | 0.248 | 0.264 |
| E1 | 5.28 | 5.48 | 0.208 | 0.216 |
| E2 | 3.40 | 3.70 | 0.134 | 0.146 |
| L | 0.70 | 1.00 | 0.028 | 0.039 |
| L1 | 0.41 | 0.71 | 0.016 | 0.028 |
| W | 1.10 | 1.40 | 0.043 | 0.055 |

Mechanical Dimensions TO-277B(New)

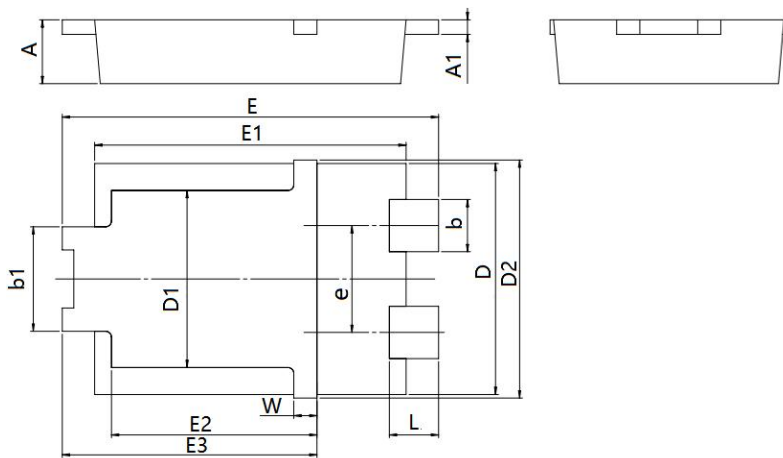

| SYMBOL | Millimeters | | Inches | |
|--------|-------------|------|--------|-------|
| | Min. | Max. | Min. | Max. |
| A | 0.95 | 1.25 | 0.037 | 0.049 |
| A1 | 0.20 | 0.30 | 0.008 | 0.012 |
| b | 0.85 | 0.95 | 0.033 | 0.037 |
| b1 | 1.70 | 1.90 | 0.067 | 0.075 |
| D | 3.88 | 4.08 | 0.153 | 0.161 |
| D1 | 2.90 | 3.20 | 0.114 | 0.126 |
| D2 | 4.00 | 4.25 | 0.157 | 0.167 |
| e | 1.74 | 1.94 | 0.069 | 0.076 |
| E | 6.30 | 6.70 | 0.248 | 0.264 |
| E1 | 5.28 | 5.48 | 0.208 | 0.216 |
| E2 | 3.40 | 3.70 | 0.134 | 0.146 |
| E3 | 4.20 | 4.60 | 0.165 | 0.181 |
| L | 0.65 | 1.05 | 0.025 | 0.041 |
| W | 0.25 | 0.55 | 0.010 | 0.022 |

Notes: New Mechanical Dimensions is performed from date code 2236X.

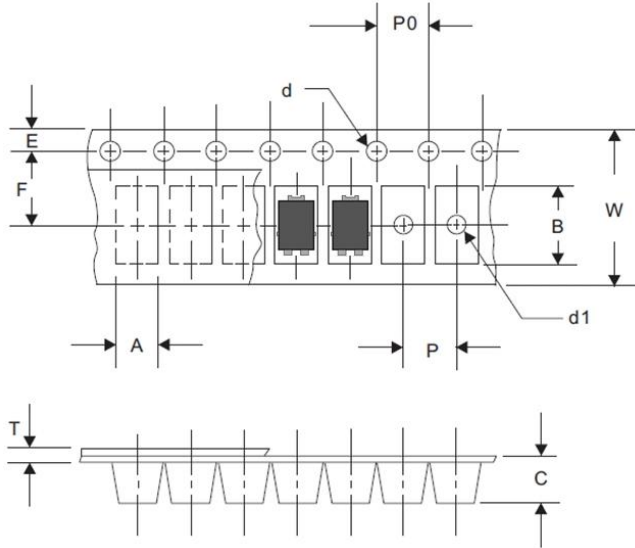
Carrier Tape Specification TO-277B

| SYMBOL | Millimeters | |
|--------|-------------|-------|
| | Min. | Max. |
| A | 4.28 | 4.48 |
| B | 6.80 | 7.10 |
| C | 1.30 | 1.50 |
| d | 1.40 | 1.60 |
| d1 | - | 1.50 |
| E | 1.65 | 1.85 |
| F | 5.40 | 5.60 |
| P | 7.90 | 8.10 |
| P0 | 3.90 | 4.10 |
| T | 0.24 | 0.44 |
| W | 11.70 | 12.30 |

Ordering Information

| Device | Package | Shipping |
|----------|------------------|---------------|
| ST560S | TO-277B(Pb-Free) | 5000pcs/ reel |
| ST560STR | TO-277B(Pb-Free) | 5000pcs/ reel |

For information on tape and reel specifications, including part orientation and tape sizes, please refer to our tape and reel packaging specification.

Marking Diagram

Where XXXXX is YYWWL

ST = Device Type
 5 = Forward Current (5A)
 60 = Reverse Voltage (60V)
 S = Package type
 YY = Year
 WW = Week
 L = Lot Number

Cautions: Molding resin
 Epoxy resin UL:94V-0

DISCLAIMER:

- 1- The information given herein, including the specifications and dimensions, is subject to change without prior notice to improve product characteristics. Before ordering, purchasers are advised to contact the SMC Diode Solutions sales department for the latest version of the datasheet(s).
- 2- In cases where extremely high reliability is required (such as use in nuclear power control, aerospace and aviation, traffic equipment, medical equipment, and safety equipment), safety should be ensured by using semiconductor devices that feature assured safety or by means of users' fail-safe precautions or other arrangement.
- 3- In no event shall SMC Diode Solutions be liable for any damages that may result from an accident or any other cause during operation of the user's units according to the datasheet(s). SMC Diode Solution assumes no responsibility for any intellectual property claims or any other problems that may result from applications of information, products or circuits described in the datasheets.
- 4- In no event shall SMC Diode Solutions be liable for any failure in a semiconductor device or any secondary damage resulting from use at a value exceeding the absolute maximum rating.
- 5- No license is granted by the datasheet(s) under any patents or other rights of any third party or SMC Diode Solutions.
- 6- The datasheet(s) may not be reproduced or duplicated, in any form, in whole or part, without the expressed written permission of SMC Diode Solutions.
- 7- The products (technologies) described in the datasheet(s) are not to be provided to any party whose purpose in their application will hinder maintenance of international peace and safety nor are they to be applied to that purpose by their direct purchasers or any third party. When exporting these products (technologies), the necessary procedures are to be taken in accordance with related laws and regulations..